



# PARISH PROFILE

## 2024



# Contents

<b>Foreword from the Associate Archdeacon</b> .....	2
<b>WELCOME!</b> .....	3
THREE CHURCHES: ONE PARISH .....	4
OUR VISION STATEMENT .....	5
OUR NEW PRIEST-IN-CHARGE .....	6
OUR CHURCH .....	8
OUR COMMUNITY.....	9
SUNDAY WORSHIP .....	11
BEYOND SUNDAY .....	13
OUTREACH AND DEVELOPING FAITH .....	15
PARISH NUMBERS .....	18
WHAT WE CAN OFFER.....	19
OUR RESOURCES .....	23
BUILDINGS .....	25



## Foreword from the Associate Archdeacon



Chalfont St Peter... Three churches in one of the largest villages in England, one in the heart of the village, one in a residential area and one in the countryside. Each one capturing a different aspect of life with God in their architecture, liturgy and outlook, but working well together through thick and thin with a desire and passion to reconnect, recover and grow.

The Celtic tradition speaks powerfully about 'thin places' where God is especially close to His people. Chalfont St Peter is such a place; not only because of the trust that those who worship there have invested in their personal and corporate relationships with God, but also through God dwelling beside congregations wearied by an unsettling recent past.

The profile highlights some of the pain of the process surrounding the resignation of the last incumbent and any applicant will need to be attentive to this. The interim nature of the post acknowledges the challenges that remain, alongside the prayerful hope that the very many mission opportunities retained through hard work, dedication and steadfastness of each congregation, can be grasped ever more firmly.

With substantial support from the Diocese and the Deanery, any appointee will also find gifted, talented and skilled – both lay and ordained – congregants to help 'make the wounded whole.'

As ever, the new Priest will be committed to the diocesan vision of becoming a more Christ-like Church for the sake of God's World – contemplative, compassionate and courageous – and to model and enable a flourishing ministry, for all, in line with the diocesan work in this area.

I commend this profile to you and I would welcome conversations about the role with interested candidates.





## **WELCOME!**

We are delighted you have opened our Parish Profile and are interested in our Parish Vacancy to become our Priest-in-Charge.

We have a big job on our hands and we need your help to make a difference in a diverse Parish family in a lovely Chiltern village.

With a growing population of over 13,000, London is easily accessible from Chalfont St Peter, yet we maintain the sense of a village community and are surrounded by countryside. The community is quite diverse and is generally affluent but contains pockets of the needy and 'just coping'.

We have three lovely churches and two church halls which enable us to offer a variety of worship at different times of the day.

Our church family has been through a difficult three years but following the resignation of our last vicar in July 2023, we have begun a process of rebuilding, and the green shoots of recovery are evident under the guidance of our team of Associate Priests and laity. There is genuine enthusiasm in our church family to rebuild in love and with a common purpose.

Our late Bishop Alan advised us that we should seek a Priest-in-Charge who can nurture and encourage our recovery, to become a beacon at the heart of the village and achieve our mission which aligns well with the Diocesan Vision in brackets:

- **ENCOUNTER GOD (Contemplative)**
- **ENCOURAGE OTHERS (Compassionate)**
- **ENGAGE OUR WORLD (Courageous)**

After an interim period, the role could become permanent by mutual agreement. We believe the right priest will be energetic with a pastoral heart, good collaborative leadership and management skills focused on the growth of a congregation which reflects the full breadth of the Anglican spectrum.

The many parishioners who contributed to our profile are eager to resume our journey, based upon and cherishing centuries of tradition, while recognising and embracing the realities and opportunities of today and tomorrow. Above all we seek to be an inclusive community where all seek to be loving and caring, welcoming and forgiving, serving and healing, where the poor can come for help, the lonely for company and the sorrowing for comfort.

We are a community where we seek faithfully the unity for which Christ prayed and to bring people closer together and closer to God.

We pray for the right leader to take us forward as we seek to follow Christ at the centre of our lives and our community. You can contact our parish office for more information.

Yours in Christ,

Matthew Locke,      John Harwood,      Michael Baxendine  
Lay Representatives on behalf of the parishioners of Chalfont St Peter



# THREE CHURCHES: ONE PARISH

While we are three churches, we are one parish, which embraces the breadth of the Anglican spectrum and has:

- A diversity of worship styles
- An inclusive community
- Strong associations with schools in the community
- A long history of bringing Christianity to the community

## OUR LOCATION



# OUR VISION STATEMENT

We strive to be a church that:

- Lives the love of Christ and has a deep faith which reaches out to the unchurched and those on the fringes especially in their teens and twenties
- Meets all people wherever they are on their spiritual journey and gives them the support they need
- Is vibrant, joyful and at the heart of the community
- Is relevant and attractive to people of all ages
- Seeks and embraces the views of our congregations
- Differentiates ourselves locally by staying true to being in the mainstream of the Anglican tradition



**ENCOUNTER GOD**

**ENCOURAGE OTHERS**



**ENGAGE OUR WORLD**





## OUR NEW PRIEST-IN-CHARGE

In preparing this Parish Profile, we have taken time to pause, reflect and then to seek as much input as possible from our congregations.

We have held three Consultation Services attended by 84 members of the church family, followed by several small groups which each held three meetings (more than 48 people attended the meetings) to discuss:

- Recent parish history
- How we might rebuild our church family
- Qualities to be sought in our new priest
- Our strengths
- Our challenges and opportunities

Our small group conversations suggest that we are seeking a new priest-in-charge who is a bit like the Angel Gabriel:

- Has experience of working within a parish in a leadership capacity
- Is sensitive to the need to rebuild trust and mutual support
- Has a pastor's heart, is people-focussed, energetic, willing to integrate with the community and be visible throughout the village
- Is keen to show the relevance of God to those on and beyond the fringes of church
- Has a balanced combination of humility and self confidence
- Is an enabler who can recognise the gifts and skills of others, empowering them to work in the service of God
- Will value and encourage both traditional and contemporary forms of worship
- Is welcoming and can communicate warmly with all ages
- Works well with children and young people and can engage with the schools
- Can touch all people from the full breadth of the Church of England and encourage people on their spiritual journeys
- Is cheerful and in possession of a good sense of humour
- Seeks input and support from the congregation

Angel Gabriel







## OUR CHURCH

Our Parish has a long and precious history of traditional worship across its three churches, complemented by the children and young families' worship in the relaxed setting of our hall.

In common with many in the country, congregations at most of our services have tended to reduce in number and advance in age. This has been exacerbated by Covid and the difficulties of the last few years which resulted in a Bishop's visitation and the resignation of the vicar.

Our recovery is built round continuing traditional patterns of service as well as alternative forms of worship for example 'The Font' on Sunday mornings - a Fresh Expressions service for families and young children. In addition, we have an annual Taizé service, special sung Eucharists with the Friends of All Saints' Festival Choir, and contemplative Holy Week services.

In order to ensure that our clergy's workloads are sustainable, our full-time stipendiary priest-in-charge will be supported by our associate priests and volunteers from the church family. We are in the process of seeking a children and families minister who can resurrect and develop the church life for young people and families.

The themes for our Mission Action Plan dated 2016 abstracted from our Vision Statement are expressed in its Priority Goals which continue to be valid:

- A wholehearted commitment to mission and outreach locally, nationally and globally to ensure that we are taking seriously the command to 'Go into all the world and make disciples'
- Further development work with children and young people to provide strong, dynamic groups, and fostering community outreach
- Outreach to children and adults of all ages
- Provide a range of services that suit different age groups and regularly review new service patterns
- Continued development of leadership, lay and ordained, specifically in terms of succession planning for clergy, key lay staff and volunteers
- Continued development of supporting administrative and lay structures

We hope to revisit the Mission Action Plan with the appointment of our new Priest.

In line with our congregations' desires there is at least one Sunday service in each of our three churches.

**“There is a lovely atmosphere in our Church  
filled with kindness and friendship.”**



## OUR COMMUNITY

Chalfont St Peter is one of the largest villages in England situated in the beautiful Chiltern Hills and is home to over 13,000 people. Despite this it retains a 'village feel' with a good community spirit expressing itself in activities such as the Feast of St Peter, Fun Night, Remembrance parades and other community events. There are many well supported clubs, societies and volunteer groups in the village.



We are largely surrounded by green belt on the edge of the Chilterns AONB with access to

a network of public footpaths to access the countryside. Over the past few years over 700 new homes have been built in the village including homes for older people.

Chalfont St Peter Council ([www.chalfontstpeter-pc.gov.uk](http://www.chalfontstpeter-pc.gov.uk)), whose members are always supportive of church activities and needs, very effectively serves the village. The village enjoys the benefits of a Leisure Centre providing swimming, gym and other facilities, a Community Centre with a hall and rooms for hire which hosts many activities and the Tithe Barn youth centre. The National Society for Epilepsy has been established in the village for over a century and some of the residents at its Centre are regular worshippers at our churches.

We are situated on the northwestern edge of Greater London, about 24 miles from The City of London with excellent access to the motorway network with a fast (average 30 minutes) and frequent mainline rail service to London Marylebone. Heathrow is 20 minutes away by road. Many people commute to London but there is some light industry and office accommodation in Chalfont St Peter making the village quite a centre for small businesses. There is a core of good quality independent traders in the village centre together with a Morrisons Daily, Marks and Spencer food store and a greengrocer.

Despite being in a postcode area that indicates one of the wealthiest districts in the country, the village is quite mixed with substantial areas of former council housing, now administered by a Housing Association.

There are three doctors' surgeries and several dental practices in the village and a small local hospital which provides a wide range of community health services. The local NHS hospitals are Wexham Park, Wycombe General and Amersham, in addition, there are two private hospitals.





In the 2021 census, religions in Chalfont St Peter were identified as:

- Christian 55.6%
- Hindu 3.9%
- Sikh 3.1%
- Muslim 1.8%
- No Religion 29.1%

Those identifying as Christian are served by the Chalfont St Peter Parish Churches in addition to Gold Hill Baptist Church, St Joseph's Roman Catholic Church and a Gospel Hall in Chalfont St Peter. Other denominations worship at St Andrew's United Reform Church and the Methodist Church in neighbouring Gerrards Cross.

We enjoy a rich spread of ages in the Parish with approximately one quarter of residents being under 18 whilst one fifth are of retirement age. Family is a strong characteristic of village life with 71% living in one family households, 60% of adults being married, with another 15% either widowed or divorced.

Whilst there are small pockets of poverty, the 2021 census showed that the majority of residents hold managerial level jobs in the professional and technical sectors.



There are four state primary schools in the village and one secondary school. With selection at 11+ in Buckinghamshire, some children move on to grammar schools in the surrounding towns. There are four private schools in the vicinity, two primary and two combined primary and secondary schools. Play groups, toddler groups and nurseries provide pre-school facilities.



## SUNDAY WORSHIP

### 8.00am HOLY COMMUNION AT ALL SAINTS

Sunday worship in the Parish commences with a said Holy Communion using Common Worship Liturgy (traditional language) at All Saints' Church at 8.00am every Sunday. The congregation meets in the choir stalls of this Arts and Crafts style church for an intimate service where they enjoy its quiet and traditional style. Vestments are worn for the service.



**“...an oasis of quiet and reflection.  
An opportunity to commune quietly and thoughtfully with God.”**

### 9.30am THE FONT

Families and young children gather in the Parish Church Hall for The Font. Following coffee, there is a contemporary service for the families and young children involving audio-visual presentations, singing, discussion, craft and other activities.

**“At the Font our children learn about God in a fun and informal way; it’s a great way for us to meet new friends: the coffee is good too!”**



### 11.00am SUNG EUCHARIST

In the Parish Church there is a Sung Eucharist using Common Worship Liturgy (contemporary language) which is led by a small choir. Vestments are worn.

**“The 11.00 service follows the traditional Sung Eucharist service with traditional, thought provoking hymns.**

**It is a quiet and reflective time, giving the perfect setting for my personal contact with God.”**

**11.00am ALL SAINTS CHURCH** on the first Sunday of the month, there is an additional Sung Eucharist using Common Worship Liturgy (contemporary language), which is followed by coffee in the Hall. Vestments are worn for the service.





## 4pm EVENSONG

Evensong is held weekly at St Paul's Church (not always sung depending on the member of clergy leading it). On the fourth Sunday, this is replaced with Holy Communion using traditional language Common Worship. Both services have hymns. St Paul's has a very committed congregation.

**“St Paul's 4 o'clock service is a special time with a special community feel.”**



## ADDITIONAL SERVICES

Supported by the Friends of All Saints' Festival Choir, special music led services are held in All Saints Church. These attract attendance from all church congregations in addition to non-church-goers, and give the opportunity to enjoy the rich organ and choral music.





## BEYOND SUNDAY

In addition to the regular services, musical concerts, sung requiems and Taizé services held from time to time provide opportunities to share our vision.

It is hoped to reinstate the midweek Holy Communion service on Wednesday mornings at St Peter's.

### FAMILIES, CHILDREN AND YOUTH WORK

While recognising the challenges of an ageing congregation and reliance upon traditional forms of worship, we know the importance of meeting the needs of families, young children and older children and are in discussion with the Diocesan Discipleship Enabler to help us to secure funding to support a Children and Families Worker and explore fresh expressions. We are excited by the many new people who have taken their first steps in the Christian faith.

We hope to relaunch the Toddler Group in the Parish Church Hall on Wednesdays and Thursdays which used to attract about 25 children and their carers to enjoy play, social time and imaginative presentation of Bible stories.



Feast of St Peter on the Common





## SCHOOLS

Chalfont St Peter Church of England Academy Our Academy (CSPA) ([www.csp-academy.org.uk](http://www.csp-academy.org.uk)) is a forward-looking and thriving junior school situated at the heart of the village very close to the Parish Church. With a capacity for 360 pupils ages 7 to 11 it has a reputation for all-round excellence. The recently appointed head teacher is keen to maintain and expand good relationships with the Parish Church. The vicar has normally been one of the governors, the majority of whom are drawn from the Christian community in the village and church governors lead collective worship monthly.

The parish also has traditionally at least one member of its leadership team/clergy on the Governing Body at Chalfont St Peter Infant School (CSPI) where the Head is keen to promote strong relationships with the Parish Church

Pupils from CSPA, CSPI, Robertswood School and Chalfont St Giles Combined School visit the church as part of their National Curriculum work and special occasions such as our annual Remembrance Service.

Members of our congregation are involved in "Open the Book" in our local schools.

Services are held in church at various points within the church calendar and final year students of CSPA are presented with a bible at a leaving service in the church.

Our involvement in the local schools is greatly appreciated with good feedback on assemblies from both teachers, parents and, of course the children!



## OUTREACH AND DEVELOPING FAITH

Establishing contact with people across our community who have little or no knowledge of the message of Our Lord is an important part of our mission and is tackled in many ways. For example, we have a visible presence at the annual village Feast Day and the Christmas Fun Night when events are organised to draw people into Church and the Parish Hall. Some examples of our groups include:

**TEA AND HYMNS** This is a well-attended informal tea party held monthly in the Parish Hall led by Revd Wendy Graham.



**LADIES FELLOWSHIP GROUP** This has been running for many years. It is a friendly group, hoping to provide an interesting lunchtime fellowship for all, especially those who live alone. Ladies of all faiths (or none) are welcome to the monthly meetings over a simple lunch.

**MEN'S GROUP** Our Men's Fellowship Group has not met recently, but it is hoped to re-establish this either with breakfast meetings or meetings in a local pub or curry house.

**FAIRTRADE COFFEE MORNING** is hosted once a month in the Parish Church Hall and is open to all.

**PASTORAL CARE** is offered as required by members of the clergy and congregation to those of advancing years, in addition to those struggling with redundancy, divorce and family tragedies and other challenges of our modern life. Regular visits are made to care homes and sheltered housing centres in the village. Communion is taken to individuals in their homes, and parishioners are visited in hospital.





**HOUSEGROUPS** currently there is a housegroup that meets every week, and we hope to encourage more to be held.

**PRAYER** There is a prayer group with monthly meetings in the Parish Church led by members of the laity. Members of our congregations attend Women's World Day of Prayer and other ecumenical prayer gatherings. We take turns at hosting the Women's World Day of Prayer.

Our larger churches have permanent prayer spaces and are open during regular times in the weekdays for private prayer.

**ECUMENICAL LINKS** Ministers and congregations from all churches meet at several forums including:

- The annual Service of Remembrance in St Peter's churchyard



- The weekly London and Slough Run
- Maria Taylor Carol Service



Image from a painting by the late Gordon King depicting an outdoor service with Chalfont St Peter Windband.



## FRIENDS OF ALL SAINTS MUSIC EVENTS

The wonderful acoustics in All Saints Church enables the Friends of All Saints to put on religious and secular musical events which enables them to raise money to contribute to the upkeep of this lovely Arts and Crafts style church. It usually involves food and refreshment.

At the end of October Faure's requiem was the setting for a sung Eucharist led by visiting musicians and Bishop Alan presiding.

A Carol service was held with a festival choir assembled in preparation for Christmas.

During May we had a festival of music on three Fridays with visiting musicians from Royal Holloway School of Music and Thorpe House School.

In June we had a Brass Ensemble and Hog roast in addition to a charity fund raising concert led by young musicians and performers in aid of ScanAppeal.

More events are planned during the year.





## BELL RINGING

We have an enthusiastic band of 11 ringers. Our Tower Captain, Steve White, and the eclectic band of spirited youngsters aged 30 to 90 ring the bells for Sunday Services and special occasions. The team hold 8 consecutive gold awards for outstanding maintenance.



## PARISH NUMBERS

In common with many churches covid 19 had a significant impact on attendances. Recent years have seen attendances and giving fall but we have entered a period of optimism and are seeing signs of a recovery. We expect this to accelerate with the appointment of our new Priest-in-Charge to lead us forward.

The parochial church electoral roll numbers 154.

In 2023, we held 3 Baptisms, 1 marriage and conducted 20 funerals (including 7 at the local crematorium).

Baptisms and marriages in 2024 have already exceeded the 2023 numbers.

Average Sunday attendances at the 3 churches over the last 6 years are:

Year	Adult	Children
2018	103	43
2019	77	67
2020	48*	16*
2021	47	17
2022	58	33
2023	51	12
2024 to date	77	20

\* Denotes average over 40 weeks Covid

Attendances over Christmas and Easter over the last 6 years

Year	Adult	Children
2018	1008	353
2019	907	494
2020	Covid	Covid
2021	132	165
2022	238	226
2023	354	230
2024 to date	165	



## WHAT WE CAN OFFER

### OUR LEADERSHIP

**Revd Wendy Graham, PTO** Wendy leads three of our traditional services twice a month in addition to occasional offices. Wendy is the 'go-to' person in the community for pastoral care having lived and worked in the village for many years. She is also active in the community and is a Director of the Community Centre.



**Revd Jennifer Locke, PTO** Jennifer is a retired vicar and leads three of our traditional services twice a month in addition to occasional offices and some family services. With the help of a member of the St Paul's congregation, she has been active in the much-needed update of the Parish website.

**Revd Jim King CBE, PTO** Jim, with his wife Sheila, have recently retired from running The Font service every week. Now taking a less active role in parish life, Jim continues to contribute his valued experience and remains busy as the Chair of Governors of our Academy and is a strong link between church and school.



**Michael Baxendine** Lay Chair and Safeguarding Co-ordinator, Michael has been lay chair for the last 6 years and has helped to guide the church through our recent difficult times.





**Matthew Locke** Churchwarden for the last year, Matthew has previous experience as a churchwarden and supports his wife in her role as a priest.



**John Harwood** Churchwarden has lived in Chalfont St Peter for many years and returned for another stint two years ago.

**Samantha Carter** Parish Administrator provides invaluable administrative support in the parish 3 days (and more) every week.



We are also very blessed with the volunteers and support groups who work tirelessly with the team including choristers and talented organists



## STRENGTHS OF OUR PARISH:

- A welcoming, friendly culture
- Good engagement with the village community
- A desire for growth
- Ecumenical links
- A strong team of committed colleagues and experienced volunteers
- A variety of services and activities
- Commitment to mutual pastoral care
- Close working relationship with our Academy
- Buildings and property generally in good order but in need of routine maintenance



## OPPORTUNITIES AND CHALLENGES:

- To nurture the process of healing, reconciliation and rebuilding
- Converting more first steps into committed discipleship
- Harnessing potential for more lay involvement in leading services
- Introducing more small groups
- Strengthening unity between three historical church congregations
- Growing numbers particularly in the 11 to 25 years age group
- Developing our current pastoral care
- Encouraging a focus on the future
- Encouraging those who are able to contribute their talent to deliver our mission



## SUPPORT WE WILL PROVIDE:

- Encouragement to maintain a sustainable ministry, including days off, holidays, retreats, opportunities for learning and development and adequate time for family life
- Financial support for an annual retreat and ministerial development
- Prayer, friendship and fellowship
- Fully reimbursed expenses
- Two Associate Priests
- Honest and timely feedback





## THE VICARAGE

We asked a friendly local estate agent to describe the vicarage. He wrote:

"A delightful four-bedroomed detached home of considerable charm and character, probably constructed in the 1930s. It stands over 100 feet back from Austenway, a quietish secondary road perfectly placed a short distance from the lovely open space of Austenwood Common. Both the Parish Church and All Saints' are within easy walking distance, but one would need to be a little fitter to reach St Paul's!

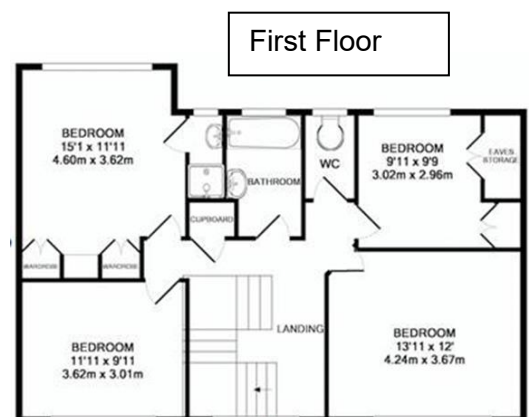

The accommodation is spacious with the benefit of double glazing and gas fired central heating and solar panels.

During the last vacancy, the property had considerable attention including a newly fitted kitchen, utility, bathroom and cloakroom together with a new boiler and rewiring, renewal of guttering and other improvements. There is a monitored burglar alarm.

The gardens to the front and rear are of reasonable size but upkeep would not be onerous. At the front there is a detached garage and visitor parking on the driveway.

All in all, a comfortable and typical home in a charming and friendly neighbourhood."

The PCC anticipates some financial assistance to the new vicar towards settling in.



## OUR RESOURCES

### FINANCIAL

Overview Generous giving in the past has enabled several signature projects. These included supplementary accommodation and welcome area at St Peter's Church in 2001 and refurbishment of the Parish Hall in 2010.

As with all churches, giving fell during Covid, a situation amplified by our recent local difficulties but we have seen a recovery since these have been resolved and we anticipate this will accelerate when we appoint a new Priest-in-Charge.

The upkeep of the fabric of All Saints benefits from the generous support of The Friends of All Saints who hold frequent fundraising activities.

Recently, the Parsonage adjacent to All Saints and the Curate's House in Fieldway have been rented out to help cover the costs of running the Parish.



### INCOME AND EXPENDITURE

Our Finance Committee aims to make best use of the financial resources available. This involves ensuring parishioners are fully aware of the financial realities of our mission with a view to increasing their regular giving and, particularly, to securing additional legacies; as well as keeping a tight control over costs.

We have been able to maintain a positive financial position due to the availability of investments and the income from the rental of the houses and hiring of the Church Halls. During 2023, we had no option than to suspend our parish share due to our difficulties but our giving is recovering and we will be resuming our Parish Share contributions during 2024.

The careful management of finances over the years has enabled the PCC to commit to fund the recruitment of a children and young families' worker in addition to a worship minister from those investments. We see these as crucial roles to support the ministry team.

We are making progress with overdue maintenance on our churches and halls although we have had to fund most of this work from investments.





## FUTURE EXPENDITURE

We will need to set aside funds to enable us to meet the Diocesan commitment to Net Zero by 2030; and also to fund the initiatives to increase outreach to young people.

Figures for the last five years and projections for 2024 are as follows:

YEAR	2019	2020	2021	2022	2023	2024 (Proj)
<b>INCOME</b>						
<b>Planned Giving</b>	112,548	95,525	83,725	41,458	33,663	45,661
<b>Lettings</b>	57,733	39,567	44,451	63,481	64,302	62,677
<b>Other Income</b>	38,526	25,253	38,508	55,026	19,249	2,039
<b>HMRC</b>	24,933	19,537	20,500	11,278	9,557	5,950
<b>Gift Day &amp; One-Off</b>	405	0.00	1,425	2,126	5,313	4,049
<b>Collections</b>	16,290	5,634	7,139	9,548	4,565	9,323
<b>Sundry Donations</b>	5,314	171	2,148	7,422	599	2,904
<b>TOTAL</b>	<b>255,749</b>	<b>185,687</b>	<b>197,896</b>	<b>190,339</b>	<b>136,953</b>	<b>132,603</b>
YEAR	2019	2020	2021	2022	2023	2024 (Proj)
<b>EXPENDITURE</b>						
<b>Running Expenditure</b>	70,387	55,455	59,348	69,900	61,986	62,000
Parish Share	84,945	86,388	85,453	82,077	13,399	20,000
Staff Costs	96,996	88,691	56,059	42,352	19,486	22,000
Charitable Giving	17,239	2,314	3,601	4,874	5,159	5,000
Maintenance	19,550	14,983	12,395	8,275	14,960	20,000
<b>TOTAL</b>	<b>289,117</b>	<b>247,831</b>	<b>216,856</b>	<b>207,478</b>	<b>114,990</b>	<b>129,000</b>

Note Projections for 2024 based on figures to end May 2024

The PCC is a Registered Charity No.1146043 and the separate Curates Endowment Fund is No. 1093547. Accounts may be downloaded from the Charity Commission website ([www.gov.uk/government/organisations/charity-commission](http://www.gov.uk/government/organisations/charity-commission)).

**Stewardship** The parish operates a developed stewardship scheme enabling parishioners to give by bank transfer, standing order or using envelopes in church. Gift aid is claimed wherever possible and provides a significant boost. A stewardship campaign is run annually when parishioners are encouraged to make an additional bonus payment as well as to review their regular giving.

**Charitable Giving** A percentage of our income is donated to charities which are sympathetic with our mission either Christian missionary or locally pastoral in nature. The Curates Endowment Fund provides some support to families who are struggling.

Additionally, several parishioners support our link with "Compassion". Individual families and groups sponsor a total of 29 children in Uganda and the churches together sponsor another young person on the same project.



## BUILDINGS

**ST PETER'S CHURCH** The present Grade II\* building in the centre of the village dates from 1715 but has been considerably altered over the years, most recently when disabled access, accessible WC, a welcome area, choir vestry, church office, new lighting and other systems were added. Seating caters for around 200 in pews.

The Parish Church and Parish Church Hall both benefit from broadband connection and a sophisticated AV system was installed in the Parish Church which enables modern music to be played and livestreaming of services.

Our busy Parish Office is located in the church which is staffed and open on three weekday mornings from 9.30am to 12.30pm.



### **ALL SAINTS' CHURCH**

All Saints' (Grade II) was built in 1912 to an 'Arts and Crafts' design by the architect Temple Moore. The church has a fine organ and its seating is flexible for up to 200 people. It accommodates concerts and other events. There is also a modern sound system to enable amplified sound and loop hearing.

The church is open for prayer from 9.00am to 12.00pm twice a week.

Upkeep and repair is supported by 'Friends of All Saints'.





**ST PAUL'S CHURCH** St Paul's is an attractive, Victorian Chapel of Ease on the outskirts of the village, built in 1864 on land given by St Thomas' Hospital, which still owns fields adjacent to the church. It seats about 40 people. An adjacent Village Hall provides social facilities on special occasions. St Paul's has the only open graveyard of our three churches.



**ST PETER'S CHURCH HALL** The Parish Church Hall, built in 1969 and extensively refurbished in 2010, is situated in the centre of the village beside the church and is used for our Font Services, Tea and Hymns, church celebrations and activities. It is also hired out for parties, meetings and exhibitions which generates a useful income. The hall has a capacity of 200 people standing and 120 people seated.



**ALL SAINTS' CHURCH HALL** A 'temporary' building which remains in good condition after some 40 years' use. All Saints' Church Hall sits behind the church in Oval Way. It is light and roomy, and is ideal for children's parties and small receptions. It has a very good level of bookings for a mother and toddlers group, adult and children's dance classes in addition to various clubs.



**THE PARSONAGE** This four-bedroom detached house next to All Saints' Church provides a family home either for use by clergy or, as it is now, let to provide additional income for the church. Maintenance and repair costs are met by the PCC which owns the property. It is planned to redecorate and carry out repairs when the current tenancy comes to an end.

**FURTHER PROPERTY** We have a three-bedroom house, owned by a separate trust, The Curate's Endowment Fund, the PCC periodically draws from the surplus income when rented. It was occupied by our children and families minister but is currently rented to a private tenant. The property has been reroofed this year, redecorated internally and externally and new double glazing fitted: all funded by the endowment fund.

**THE VICARAGE** is owned by the Diocese All of the properties in the Parish estate are in a generally good state of repair although we are in the process of attending to some backlog maintenance. A programme of brick and stonework repairs has made a good start and is planned for completion before the next Quinquennial Inspection in 2024.

**HOUSE PRICES AND THEIR CONSEQUENCES** House prices are high in Chalfont St Peter which usually precludes newly married couples from purchasing their own home in the area. Families with young children are, however, attracted to the area by the exceptional education in the county and there is considerable migration from West London.

**NEW DEVELOPMENT** The Neighbourhood Plan housing needs assessment has identified sites for further housing development in the area. See [www.chalfontstpeter-pc.gov.uk/wp-content/uploads/sites/95/2021/03/Chalfont-St-Peter-Housing-Needs-Assessment-Report\\_Final-Report.pdf](http://www.chalfontstpeter-pc.gov.uk/wp-content/uploads/sites/95/2021/03/Chalfont-St-Peter-Housing-Needs-Assessment-Report_Final-Report.pdf)





of Chalfont Park,  
by his relations, friends and neighbours.  
1887.



“There’s always so much going on at this church it’s a really thriving place.”